

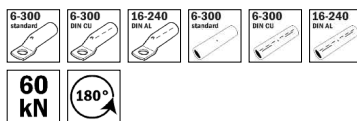

**Mechanical hand  
pliers „MO-6“**

**Art. 216804**



**haupa**<sup>®</sup>

**... convincing solutions**

## 1. Technical data

Area of application:	For the creation of an electrical connection by means of compression
Scope of delivery:	Mechanical hand pliers in a black plastic case, without dies.
Safety:	The tool is fitted with a safety value that has been set at the factory.
Structure:	The working head can be rotated by 180° to make it easier to adapt to the operation to be carried out. The crimping tool does not protect the operator when working on cables that carry power.
Guarantee:	2 year guarantee if used for the purpose it is intended

## 2. Area of work

- Crimping range cable lugs: standard Cu 6-300
- DIN Cu 6-300 • DIN Al 16-240
- Crimping range connectors: standard Cu 6-300
- DIN Cu 6-300 • DIN Al 16-240
- Weight in kg: 3,5
- Weight set in kg: 5,0

## 3. Operating instructions

**CAUTION! TOOLS MAY NEVER BE USED WITHOUT FIRST INSERTING THE PRESSING DIES.**  
Ensure that the pressing dies fit precisely to the appropriate area and are seated perfectly in the holders.  
**OTHERWISE THIS MAY CAUSE SERIOUS DAMAGES OR BREAKAGES AND THE GUARANTEE WILL BE VOIDED.**

### Introduction:

Before starting up the tool, read the operating instructions first.  
All current-carrying elements in the area you are working in should be disconnected. Otherwise the protective procedures for working in the vicinity of components under current must be implemented. (DIN EN 50110).  
Do not use the tool if you are tired or under the influence of medication, drugs or alcohol. Take into account the valid accident prevention and safety regulations and use the tool exclusively for the purpose for which it is intended.  
The operating instructions must always be carried with the tool.  
The instructions must have been read and understood by the user.  
The operator must ensure that this is the case.

### Performance characteristics:

- 6 tonnes of pressing force for maximum performance
- 180° rotating crimping head. Can thus be mounted even in places that are difficult to access.
- The manual return enables the operator to bring the piston back to the starting point in the event of a faulty pressing.

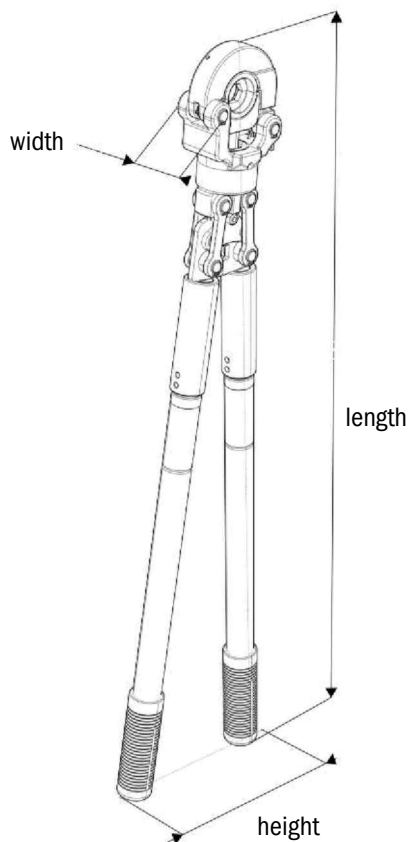

#### 4. Operating instructions Art. no. 216804

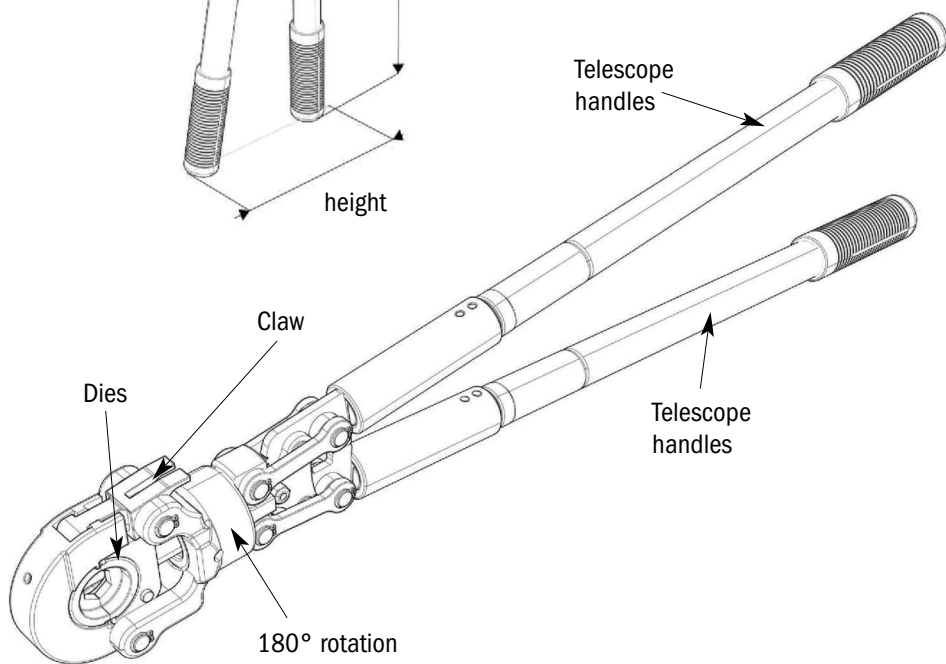

**haupa**<sup>®</sup>  
... convincing solutions

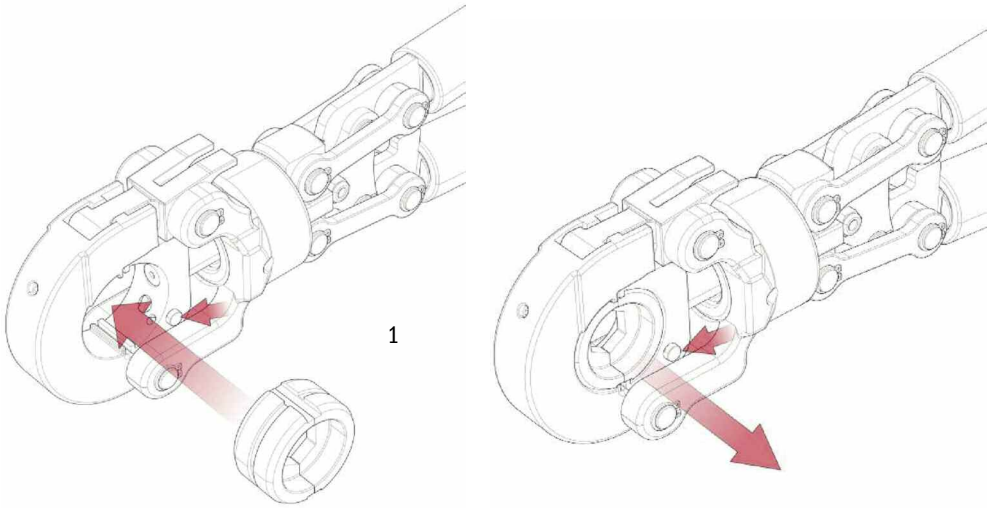

- Set suitable dies to the position, like picture 1

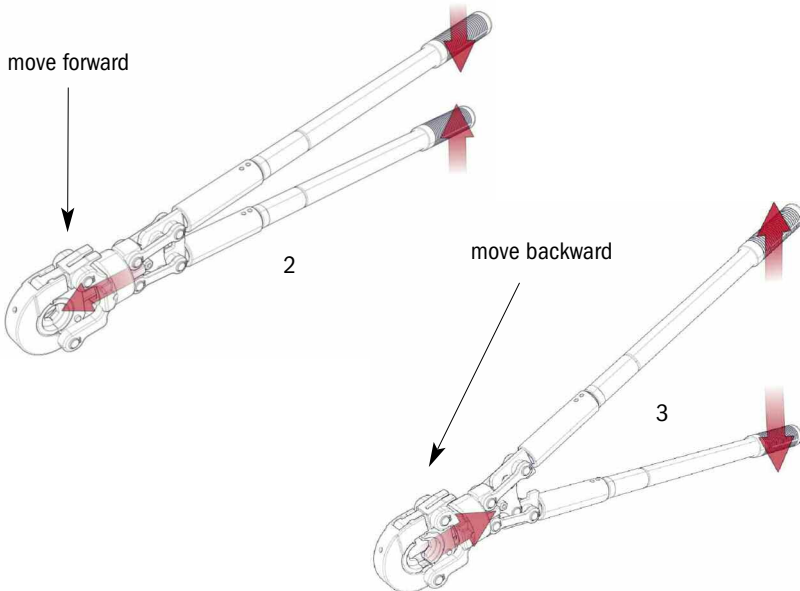

picture 2: move forward and crimp  
picture 3: move backward and well crimped

- while crimping, the dies move forward to the max. highest position and the protruding points of two handles are touched, like picture 4

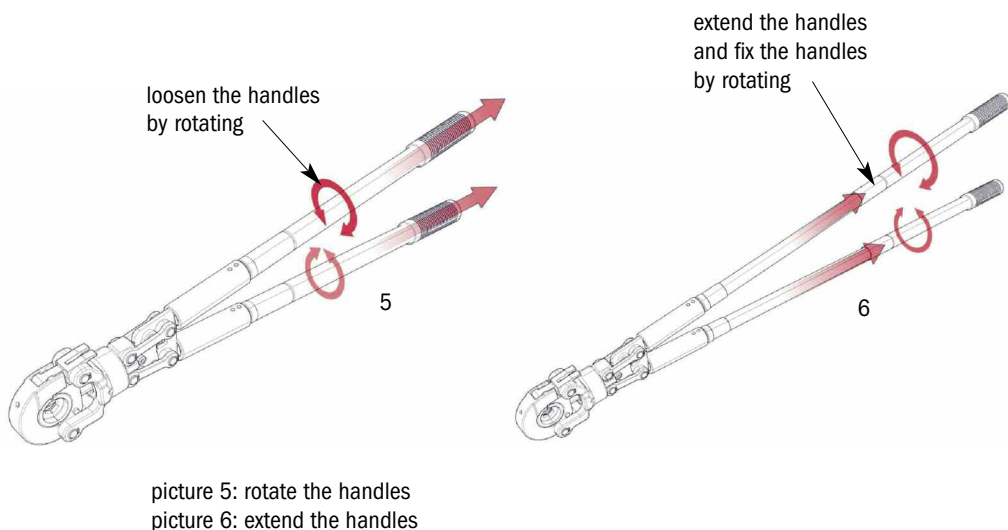
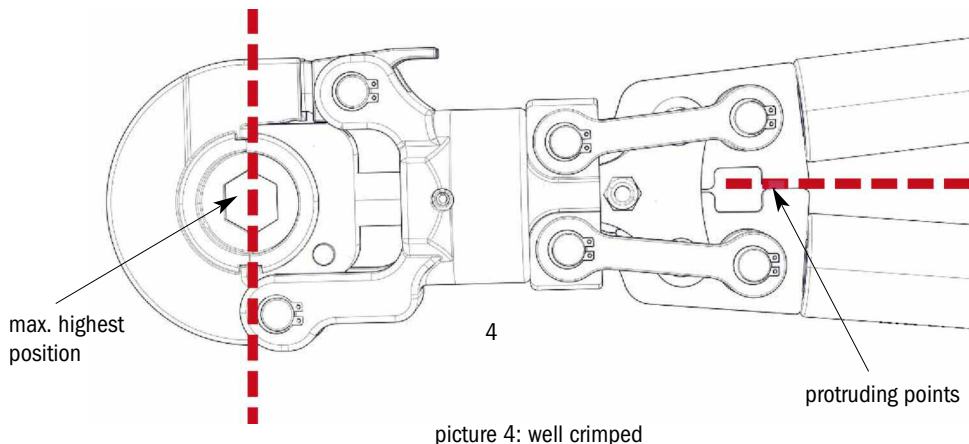

## **5. Care and maintenance**

### **5.1. Cleaning**

Careful cleaning of the tool, in particular, the moving parts contributes towards a longer useful life. Remember that dust, sand, environmental influences, in particular a high salt index, and dirt in general are extremely damaging to mechanical tools.

### **5.2. Storage**

To prevent damage to the tool as a result of bumps, dust etc. you should if possible store the tools in the carry bag in a warehouse.

WITH EVERY REPLACEMENT PART ORDER, INCLUDE THE FOLLOWING INFORMATION:

- 1) Article number
- 2) Article description
- 3) Reference to the operating instructions and/or date
- 4) Tool type
- 5) Serial number of the tool

The guarantee is voided if you use parts that are not original replacement parts from HAUPA.