

## Rohrkabelschuhe, Ringform, aus Reinnickel

- **Werkstoff: Nickel**
- **Temperaturbeständigkeit bis 500° C**



**Ni**

| Art. Nr. | LQ  | M | d2  | d1  | A    | I   | kg/100 | VE  |
|----------|-----|---|-----|-----|------|-----|--------|-----|
| 292560   | 0,5 | 4 | 4,3 | 1,6 | 13,0 | 6,0 | 0,105  | 100 |
| 292562   |     | 5 | 5,3 | 1,6 | 14,0 | 6,0 | 0,086  | 100 |
| 292564   | 1,5 | 4 | 4,3 | 2,3 | 13,0 | 6,0 | 0,109  | 100 |
| 292566   |     | 5 | 5,3 | 2,3 | 14,0 | 6,0 | 0,122  | 100 |
| 292568   |     | 6 | 6,5 | 2,3 | 16,0 | 6,0 | 0,134  | 100 |
| 292570   | 4   | 4 | 4,3 | 3,6 | 18,0 | 8,0 | 0,300  | 100 |
| 292572   |     | 5 | 5,3 | 3,6 | 19,0 | 8,0 | 0,200  | 100 |
| 292574   |     | 6 | 6,5 | 3,6 | 19,0 | 8,0 | 0,300  | 100 |

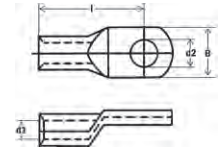

## Rohrkabelschuhe, Gabelform, aus Reinnickel

- **Werkstoff: Nickel**
- **Temperaturbeständigkeit bis 500° C**



**Ni**

| Art. Nr. | LQ  | M | d2  | d1  | A    | I   | kg/100 | VE  |
|----------|-----|---|-----|-----|------|-----|--------|-----|
| 292580   | 0,5 | 4 | 4,3 | 1,6 | 13,0 | 6,0 | 0,073  | 100 |
| 292582   |     | 5 | 5,3 | 1,6 | 14,0 | 6,0 | 0,070  | 100 |
| 292584   | 1,5 | 4 | 4,3 | 2,3 | 13,0 | 6,0 | 0,100  | 100 |
| 292586   |     | 5 | 5,3 | 2,3 | 14,0 | 6,0 | 0,100  | 100 |
| 292588   |     | 6 | 6,5 | 2,3 | 16,0 | 6,0 | 0,110  | 100 |
| 292590   | 4,0 | 4 | 4,3 | 3,6 | 18,0 | 8,0 | 0,300  | 100 |
| 292592   |     | 5 | 5,3 | 3,6 | 19,0 | 8,0 | 0,300  | 100 |

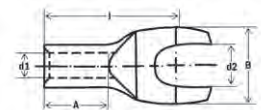

## Stoßverbinder aus Reinnickel

- **Werkstoff: Nickel**
- **Temperaturbeständigkeit bis 500° C**



**Ni**

| Art. Nr. | LQ        | d1  | GL | kg/100 | VE  |
|----------|-----------|-----|----|--------|-----|
| 292596   | 0,5 - 1   | 1,6 | 15 | 0,101  | 100 |
| 292598   | 1,5 - 2,5 | 2,3 | 15 | 0,110  | 100 |
| 292600   | 4 - 6     | 3,6 | 15 | 0,190  | 100 |

