

Presskabelschuhe DIN 46235

DIN

- Werkstoff: 99,9% Elektrolyt-Kupfer, geglähtes Material, E-CU DIN 40500
- Oberfläche: blank gebeizt
- Pressmarkierung



Cu

Art. Nr.	LQ	M	KZ	d2	d1	d4	A	v1	v2	l	c1	c2	B	kg/100	VE	VE
290001	6	5	5	5,3	3,8	5,5	10,0	2	-	24,0	6,5	7,5	8,5	0,300	800	100
290003		6	5	6,4	3,8	5,5	10,0	2	-	24,0	7,5	8,0	8,5	0,300	800	100
290005		8	5	8,4	3,8	5,5	10,0	2	-	24,0	10,0	10,0	13,0	0,300	800	100
290007	10	5	6	5,3	4,5	6,0	10,0	2	-	27,0	7,0	8,5	9,0	0,700	800	100
290011		6	6	6,4	4,5	6,0	10,0	2	-	27,0	7,5	8,5	9,0	0,600	800	100
290013		8	6	8,4	4,5	6,0	10,0	2	-	27,0	10,0	10,0	13,0	0,300	800	100
290015		10	6	10,5	4,5	6,0	10,0	2	-	28,0	10,0	10,0	15,0	0,500	800	100
290019	16	6	8	6,4	5,5	8,5	20,0	2	1	36,0	7,5	8,0	13,0	1,100	500	50
290021		8	8	8,4	5,5	8,5	20,0	2	1	36,0	10,0	10,0	13,0	1,100	400	50
290025		10	8	10,5	5,5	8,5	20,0	2	1	36,0	12,0	12,0	17,0	1,200	400	50
290027		12	8	13,0	5,5	8,5	20,0	2	1	36,0	13,0	13,0	18,0	1,200	400	50
290031	25	6	10	6,4	7,0	10,0	20,0	2	1	38,0	7,5	8,0	14,0	1,300	300	50
290033		8	10	8,4	7,0	10,0	20,0	2	1	38,0	10,0	10,0	16,0	1,400	300	50
290035		10	10	10,5	7,0	10,0	20,0	2	1	38,0	12,0	12,0	17,0	1,600	300	50
290037		12	10	13,0	7,0	10,0	20,0	2	1	38,0	13,0	13,0	19,0	1,400	300	50
290039	35	6	12	6,4	8,2	12,5	20,0	2	1	42,0	7,5	8,0	17,0	2,700	150	25
290042		8	12	8,4	8,2	12,5	20,0	2	1	42,0	10,0	10,0	17,0	2,900	150	15
290044		10	12	10,5	8,2	12,5	20,0	2	1	42,0	12,0	12,0	19,0	3,000	150	25
290049		12	12	13,0	8,2	12,5	20,0	2	1	42,0	13,0	13,0	21,0	2,800	150	25
290050	50	8	14	8,4	10,0	14,5	28,0	3	1	52,0	10,0	10,0	20,0	4,500	100	25
290051		10	14	10,5	10,0	14,5	28,0	3	1	52,0	12,0	12,0	22,0	4,400	100	25
290052		12	14	13,0	10,0	14,5	28,0	3	1	52,0	13,0	13,0	24,0	4,400	100	25
290053		16	14	17,0	10,0	14,5	28,0	3	1	52,0	16,0	16,0	28,0	4,300	100	20
290054	70	8	16	8,4	11,5	16,5	28,0	3	1	55,0	10,0	10,0	24,0	5,900	100	25
290055		10	16	10,5	11,5	16,5	28,0	3	1	55,0	12,0	12,0	24,0	6,000	100	25
290056		12	16	13,0	11,5	16,5	28,0	3	1	55,0	13,0	13,0	24,0	5,300	100	25
290057		16	16	17,0	11,5	16,5	28,0	3	1	55,0	16,0	16,0	30,0	5,600	80	20
290058	95	10	18	10,5	13,5	19,0	35,0	4	2	65,0	12,0	12,0	28,0	8,900	60	15
290059		12	18	13,0	13,5	19,0	35,0	4	2	65,0	13,0	13,0	28,0	8,500	60	15
290060		16	18	17,0	13,5	19,0	35,0	4	2	65,0	16,0	16,0	32,0	8,700	60	15
290061	120	10	20	10,5	15,5	21,0	35,0	4	2	70,0	15,0	16,0	32,0	11,100	40	20
290063		12	20	13,0	15,5	21,0	35,0	4	2	70,0	16,0	17,0	32,0	11,000	40	20
290064		16	20	17,0	15,5	21,0	35,0	4	2	70,0	19,0	20,0	32,0	10,600	40	20
290065		20	20	21,0	15,5	21,0	35,0	4	2	70,0	21,0	22,0	38,0	11,100	40	20
290066	150	10	22	10,5	17,0	23,5	35,0	4	2	78,0	15,0	16,0	34,0	15,800	30	15
290067		12	22	13,0	17,0	23,5	35,0	4	2	78,0	16,0	17,0	34,0	15,600	30	15
290068		16	22	17,0	17,0	23,5	35,0	4	2	78,0	19,0	20,0	34,0	15,700	30	15
290069		20	22	21,0	17,0	23,5	35,0	4	2	78,0	21,0	22,0	40,0	15,800	30	12
290070	185	10	25	10,5	19,0	25,5	40,0	4	2	82,0	15,0	16,0	37,0	17,200	20	10
290071		12	25	13,0	19,0	25,5	40,0	4	2	82,0	16,0	17,0	37,0	18,300	20	10
290072		16	25	17,0	19,0	25,5	40,0	4	2	82,0	19,0	20,0	37,0	17,700	20	10
290073		20	25	21,0	19,0	25,5	40,0	4	2	82,0	21,0	22,0	40,0	18,900	20	10
290074	240	12	28	13,0	21,5	29,0	40,0	5	2	92,0	16,0	17,0	42,0	26,400	16	8
290075		16	28	17,0	21,5	29,0	40,0	5	2	92,0	19,0	20,0	42,0	26,900	16	8
290076		20	28	21,0	21,5	29,0	40,0	5	2	92,0	21,0	22,0	45,0	26,900	16	8
290077	300	16	32	17,0	24,5	32,0	50,0	-	2	100,0	19,0	22,0	46,0	33,000	8	4
290078		20	32	21,0	24,5	32,0	50,0	-	2	100,0	19,0	22,0	46,0	33,000	8	4
290079	400	16	38	17,0	27,5	38,5	70,0	-	3	115,0	25,0	25,0	55,0	70,200	6	6
290080		20	38	21,0	27,5	38,5	70,0	-	3	115,0	25,0	25,0	54,0	45,100	6	6
290081	500	20	42	21,0	31,0	42,0	70,0	-	3	125,0	25,0	25,0	60,0	76,600	6	6
290082	625	20	44	21,0	34,5	44,0	80,0	-	3	125,0	25,0	25,0	64,0	78,000	1	1
290083	800	20	52	21,0	40,0	52,0	100,0	-	3	165,0	30,0	30,0	75,0	148,600	1	1
290084	1000	20	58	21,0	44,0	58,0	100,0	-	3	165,0	30,0	30,0	83,0	195,200	1	1

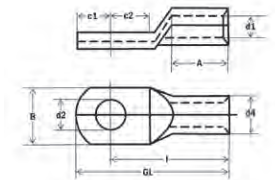

Pressverbinder DIN 46267 Teil 1

DIN

- **Werkstoff: 99,9% Elektrolyt-Kupferrohr, geglähtes Material**
- **nach DIN 40500, für zugentlastete Verbindungen**
- **Oberfläche: blank gebeizt**
- **Pressmarkierung**



Cu

Art. Nr.	LQ	KZ	d1	d4	v1	v2	GL	kg/100	VE
291520	6	5	3,8	5,5	2	-	30	0,300	1600
291522	10	6	4,5	6,0	2	-	30	0,600	1000
291524	16	8	5,5	8,5	2	1	50	1,450	300
291526	25	10	7,0	10,0	2	1	50	1,700	300
291528	35	12	8,2	12,5	2	1	50	3,100	200
291530	50	14	10,0	14,5	3	1	55	4,400	100
291532	70	16	11,5	16,5	3	1	55	5,300	100
291534	95	18	13,5	19,0	4	2	70	8,400	50
291536	120	20	15,5	21,0	4	2	70	9,600	50
291538	150	22	17,0	23,5	4	2	80	14,500	30
291540	185	25	19,0	25,5	4	2	85	16,200	30
291542	240	28	21,5	29,0	5	2	90	22,400	20
291544	300	32	24,5	32,0	-	2	100	29,500	10
291546	400	38	27,5	38,5	-	3	150	72,500	8
291548	500	42	31,0	42,0	-	3	160	85,600	5
291550	625	44	34,5	44,0	-	3	160	79,900	6
291552	800	52	40,0	52,0	-	3	200	151,000	6
291554	1000	58	44,0	58,0	-	3	1000	198,000	6

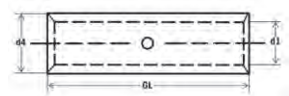

Pressverbinder nach DIN 48085, Teil 1

DIN

- **Werkstoff: 99,9% Elektrolyt-Kupferrohr, geglähtes Material**
- **nach DIN 40500, für zugfeste Verbindungen, Freileitungsbau**
- **Oberfläche: blank gebeizt**
- **Pressmarkierung**



Cu

Art. Nr.	LQ	KZ	d1	d4	v1	v2	GL	kg/100	VE
291440	6	6	3,8	6,5	8	-	65	1,200	50
291442	10	8	4,5	8,5	10	-	80	2,800	50
291444	16	8	5,5	8,5	10	-	95	2,300	50
291446	25	10	7,0	10,0	10	-	95	2,600	50
291448	35	12	8,2	12,5	10	-	95	5,800	25
291450	50	14	10,0	14,5	10	-	110	7,000	25
291452	70	16	11,5	16,5	10	-	110	9,000	25
291454	95	20	13,5	21,0	16	8	145	8,600	10
291456	120	22	15,0	23,5	16	8	160	29,200	10
291458	150	25	16,5	25,5	16	8	180	117,100	10
291460	185	32	18,5	31,5	-	10	260	17,000	5
291462	240	34	21,0	34,5	-	12	310	163,700	5
291464	300	38	23,5	38,5	-	14	360	29,200	5

